

# Getting started with the Stattox 560

**This instruction is for quick orientation!**

**Prior to installation and operation please download and read the detailed manual. Manuals in several languages are accessible on our homepage [www.compur.com](http://www.compur.com).**

## 1 Safety Advice

- Read and observe this manual carefully. Store it in a safe place.
- The Stattox 560 must not be operated other than in the specified ambient conditions (see Technical Data, page 10).
- In particular the regulations with regards to the protection regulations for instance DIN EN 60079-14 must be observed.
- Installation must be performed by trained and authorized personnel. Only original Compur Monitors parts may be used.
- The Stattox 560 must not be connected to mains! The supply voltage is 24 (16-30) VDC.
- All outputs of the Stattox 560 may only be operated with 30 VDC.
- Damaged or modified sensor heads must not be used.
- The Ex d housing must not be opened!
- When operated in hazardous atmosphere, the sensor head must be connected to the exLink counterpart or to a certified connection box.

**Disregarding these recommendations may compromise the Ex protection and result in a danger for personnel and assets.**

## 2 Installation

Leaving the stainless steel protective cylinder and the protective cap on the instrument protects it from pollution.

Install the Stattox 560 sensor head in upright position to the wall. Use two M8 screws and suitable washers.

Compur Monitors offers an Ex e rated terminal box (art. # 562988) made of varnished cast aluminum.

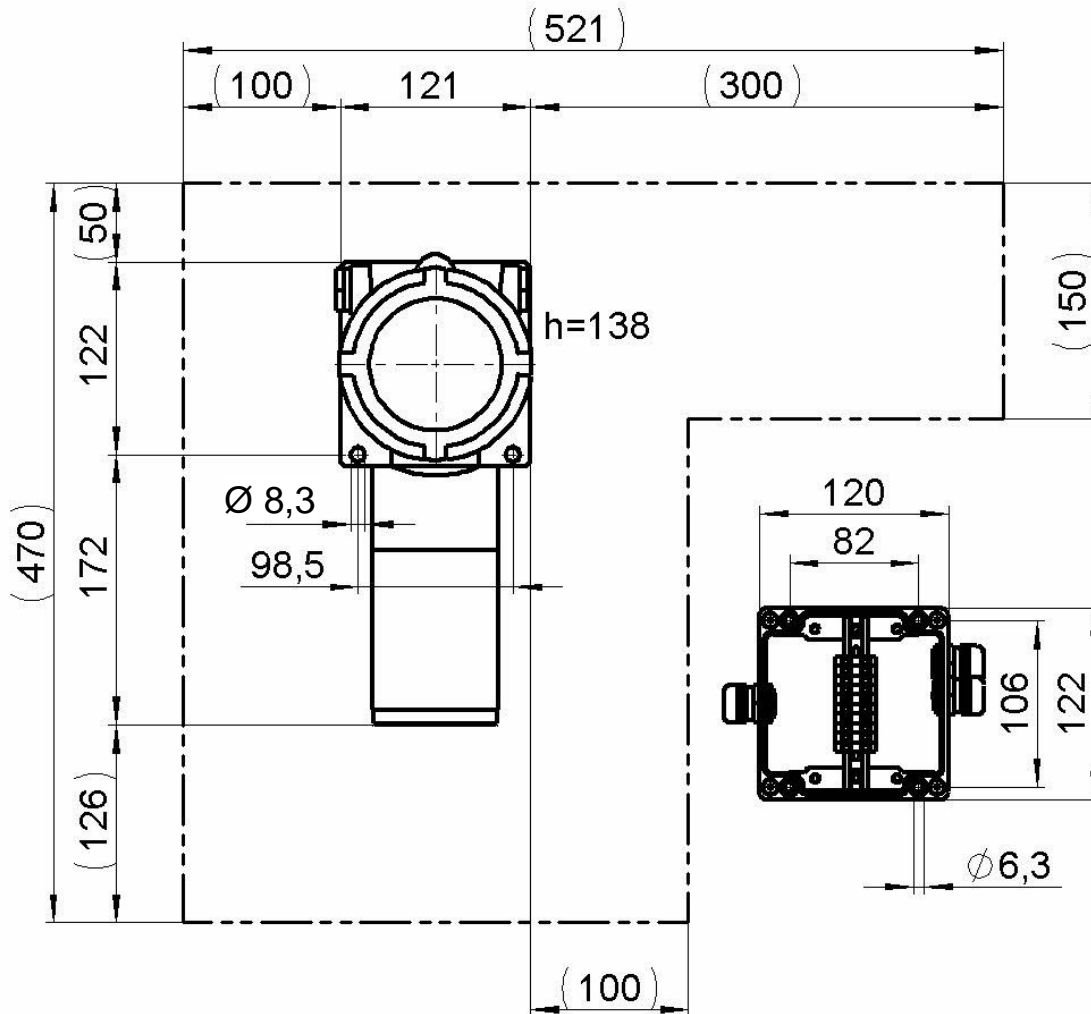

Picture 1: Stattox 560 dimensions in mm and the space needed for safe and easy operation.

Outer dimensions and drill plan of the junction box, article number 562988.



Do not open the blue flame - proof housing!

### 3 Connection

#### 3.1 Stattox 560 Cable Tail Version Connection

The cable tail must be connected to a suitable EMC junction box made of metal. When installed in a hazardous area this must be certified Ex e and have 10 terminals and EMC resistant cable glands. Computor Monitors recommends to use fine meshed cable  $\geq 0.75 \text{ mm}^2$  for instance type Oelflex 415 CP.



Stattox 560 must be operated with 24 (16-30) VDC. Connecting it to higher voltages or short circuiting the outputs may destroy it.

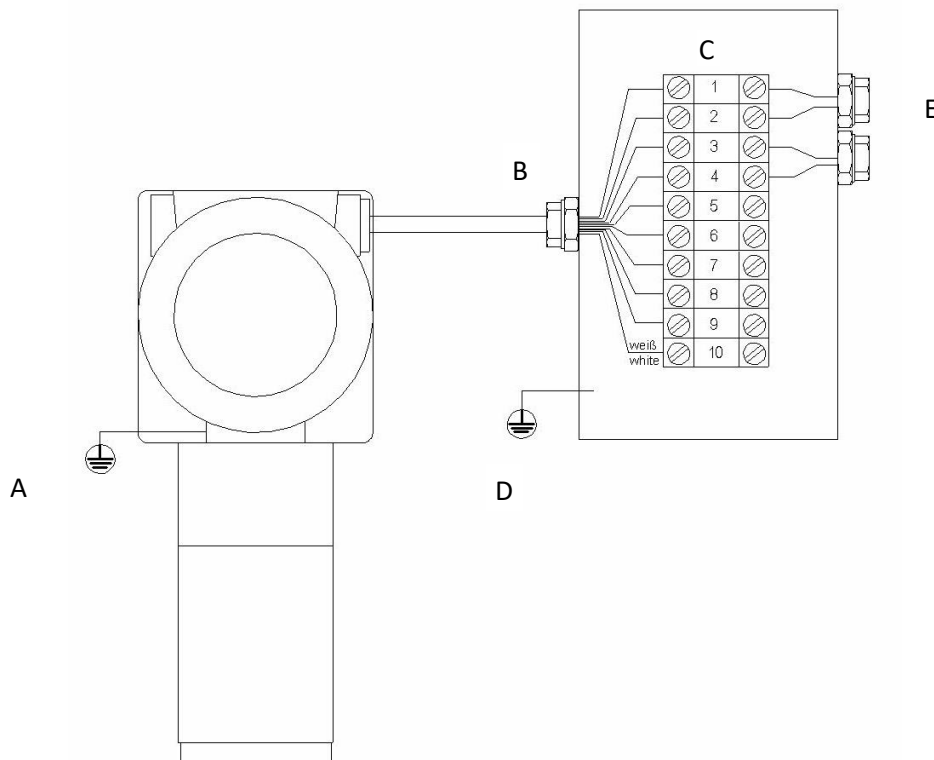

Picture 2: Stattox 560 cable tail connection

**Caution:**

- A. Connect the grounding contact to the ground of the building, using a cable diameter  $\geq 6 \text{ mm}^2$ .
- B. Remove the protective tube from the cable shield and insert the cable through the EMC – proof cable gland. Remark: the cable shield is not connected to the sensor head housing!
- C. Connect the cores in the sequence of their numbers to the terminals, the white core to terminal 10. All cores must be connected, even if you do not use them all.
- D. Connect the grounding contact of the junction box to the ground of the building. Use a cable with  $\geq 4 \text{ mm}^2$  diameter.
- E. The number of outgoing cable glands depends on your application.



- Do not try to remove the cable tail from the sensor head. It will destroy it!
- Never leave loose cable ends in the terminal box!
- Proper grounding is essential for error-free operation!

Wire	Function	Description
1	+24 VDC	+ 24 V Power supply (16-30 VDC)
2	0 VDC	Power supply ground
3	I_OUT+	0-22 mA Current output
4	I_OUT-	Current output ground
5	Remote self-test	Remote self-test trigger
6	GND_R	Common ground for all relays
7	Maintenance request	Relay output maintenance request (open drain)
8	System failure	Relay output System failure (open drain)
9	A2	Relay output Alarm 2 (open drain)
wt	A1	Relay output Alarm 1 (open drain)

Table 1: Connecting the cable tail

### 3.2 Stattox 560 connecting the eXLink-Plug

The Stattox 560 eXLink-Version (7 pole) has a plug installed in the housing. The counterpart must be installed by the user and can be connected to a junction box if necessary. The eXLink can be connected and disconnected in hazardous areas without hot work permit.

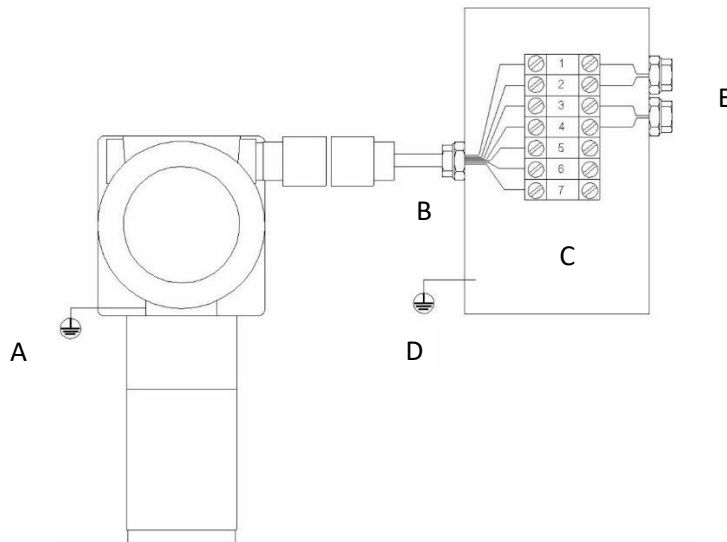

Picture 3: Connection of the eXLink

Please observe points A to E in chapter 3.1, they apply to this application method, too. It is not mandatory to connect all contacts on the field side.

Do not connect the cable shield to the coupling!

Use only coupling Compur Art. # 805594. Observe its installation instructions.



- Take care for correct wiring! Wrong pin assignment may damage the Stattox 560!
- Do not try to dismount the eXLink from the sensor head. This is a potted joint. Loosening it will destroy Ex d rating of the housing!

Pin assignment:

Contact	Function	Description
1	+24 VDC	+ 24 V Power supply (16-30 VDC)
2	0 VDC	Power supply ground
3	I_OUT+	0-22 mA Current output
4	I_OUT-	Current output ground
5	Remote Self-test	Remote self-test trigger
6	GND_R	Common ground for relays
7	Maintenance Request	Relay maintenance request (open drain)



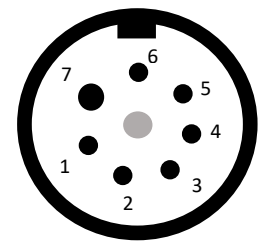
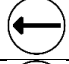

Table 2: Pin assignment Stattox 560 eXLink-plug



Picture 4:  
Pin assignment eXLink-plug

## 4 Keys

Stattox 560 can be operated through the window with a magnetic pin. The magnetic pin activates hall sensors inside the sensor head. Just hold the slim part of the pin next to the key. The individual keys have the following functions:

Keys	Function
 Enter	Confirm entries.
 Reset	Delete false settings. Step back to the recent menu. Reset alarms.
 Left	Navigates left in the menu, reduces a set value, and accesses the service menu.
 Right	Navigates right in the menu, increases a set value, and accesses the info - menu.

## 5 Getting started and menu navigation

Remove the yellow protective cap and unscrew counterclockwise the stainless steel protection cylinder. If there is a short circuit bridge at the sensor module (applicable for 2 electrode sensors) remove it. Insert the guiding pins into the relevant drill holes to connect the sensor module by pushing it carefully upward (see picture 5).

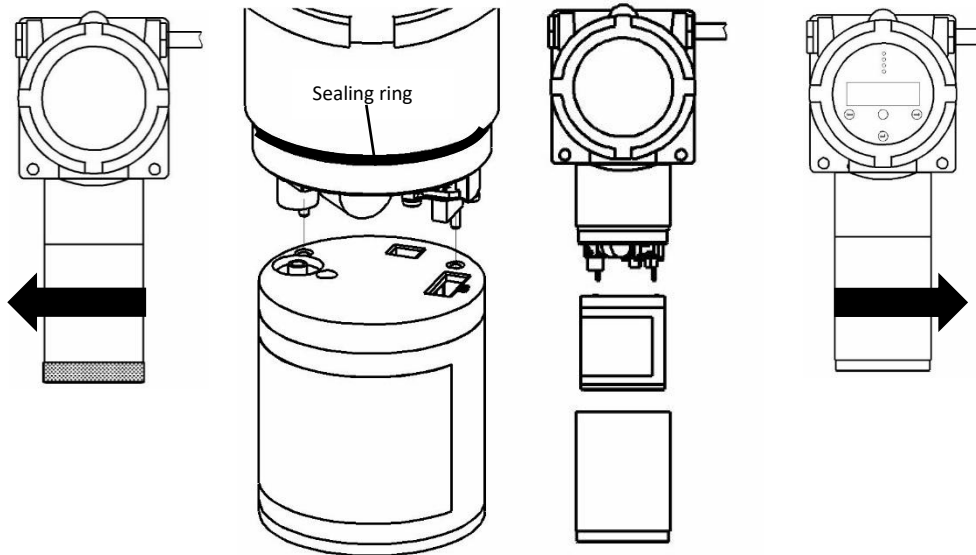

Picture 5: Connecting the sensor module

Now fingertight fasten the protection cylinder. The sealing ring must be clean!  
The warm-up procedure (see picture 6) can take some minutes, especially with 3-electrode-sensors. After the warm-up, the Stattox 560 will go into the measuring mode.

The following settings must be done after the start-up:

- Set the real time clock
- Set the self-test parameters
- Set the alarm relays



Change the sensor module only in the menu **Change Sensor** in order to avoid a data loss in the sensor memory.

The following schematics show the warm-up and an overview of the main menu of the Stattox 560 with a short description.

Hint:

When the symbol \* appears on right upper side of the display, internal diagnostics are made. During this time, the buttons are not active and there is no display update!

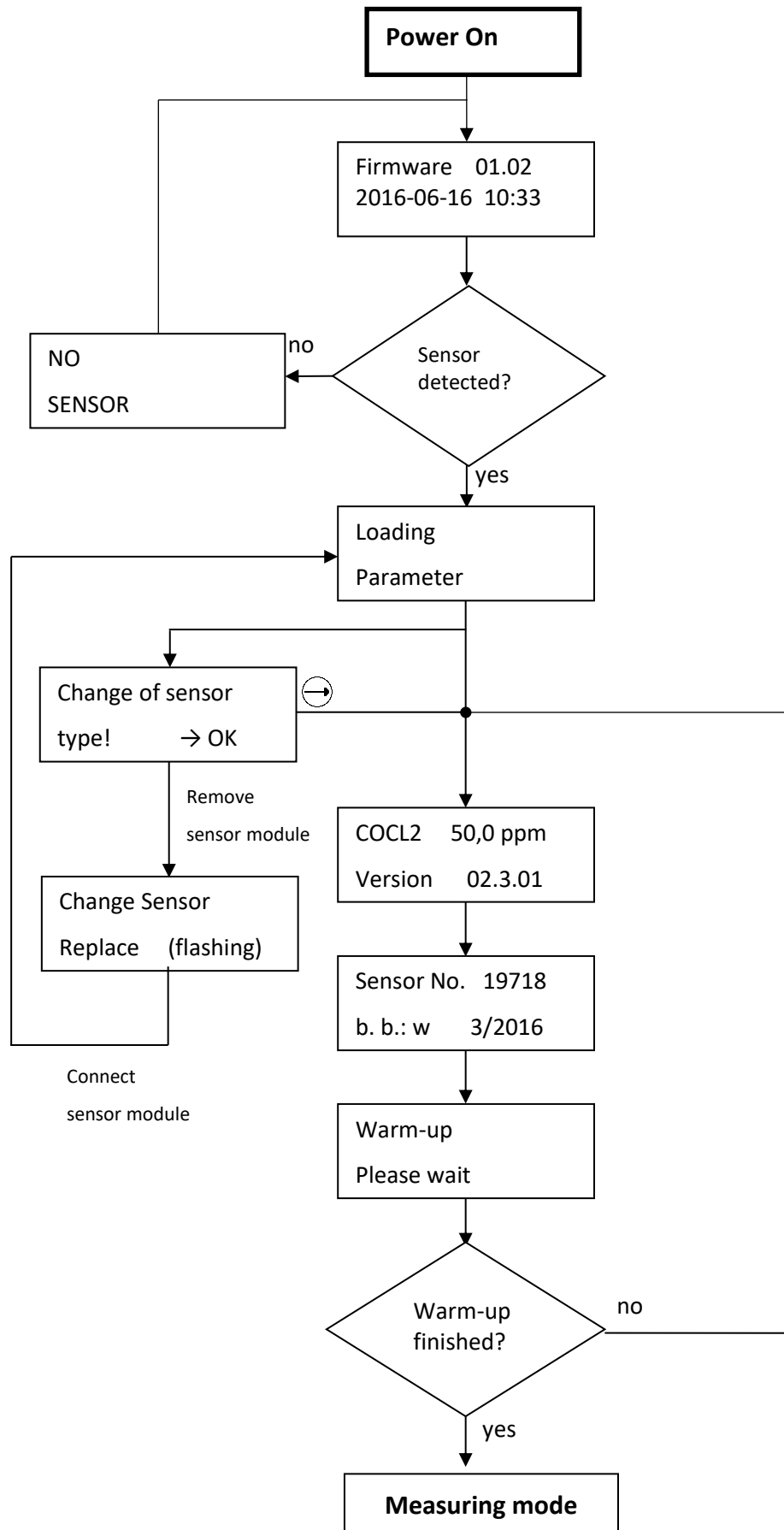

Picture 6: Schematics warm-up

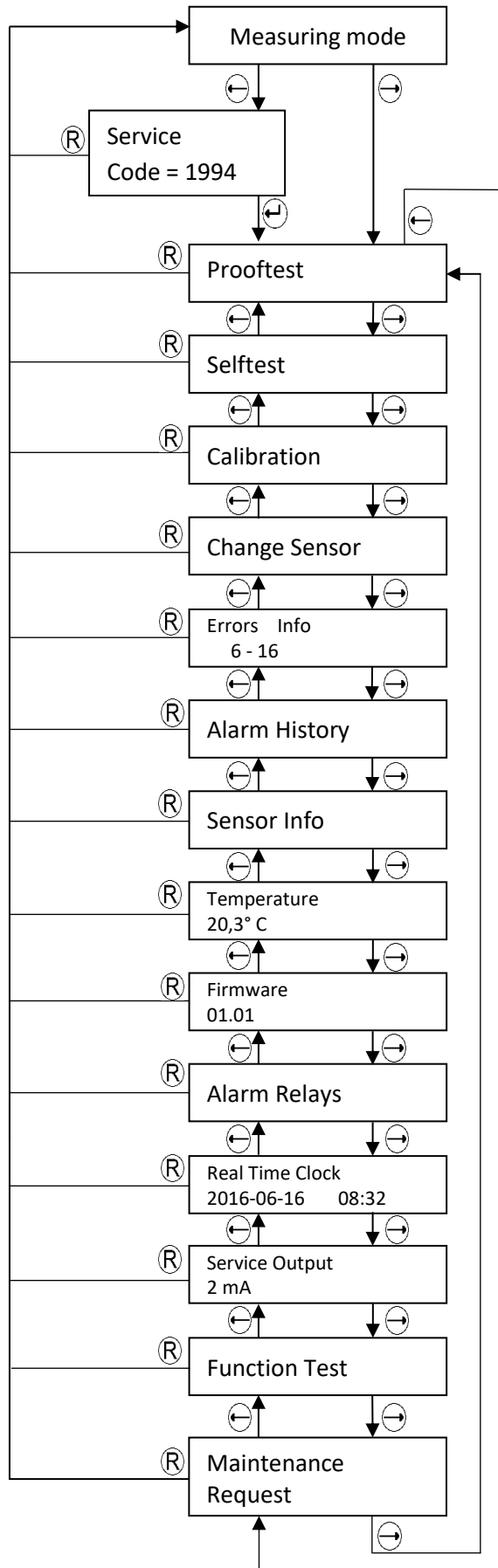

**Short description:**

- Prooftest start
- Self - test start, set self - test schedule
- Sensor calibration
- Sensor module replacement
- Error Code info
- Alarm history
- Sub menus sensor info
- Display the current temperature
- Display the current Firmware
- Sub menus alarm settings
- Time and date settings
- Setting of the analog output during service
- Test of the alarms, display and mA-output
- Maintenance request settings

**Picture 7: Main menu**



## 6 System Status

If the display is dark and green LED off, the power supply voltage is off, too low or its polarity is wrong. If none of this is the case, a burned out fuse might be the reason.



Replacement of the fuse must be done by Compur Monitors!

System status	Analog output	Display	LEDs				switching outputs <sup>4)</sup>			
			A1 yellow	A2 yellow	SF red	ON green	A1 <sup>3)</sup>	A2 <sup>3)</sup>	WB <sup>3)</sup>	SF
Measuring mode	4 - 20 mA	Measured value <sup>8)</sup>	OFF	OFF	OFF	ON	passive	passive	passive	active
Alarm 1 <sup>2)</sup>	4 - 20 mA	Measured value	ON	OFF	OFF	ON	active	passive	passive	active
Alarm 2 <sup>2)</sup>	4 - 20 mA	Measured value	ON	ON	OFF	ON	active	active	passive	active
Out of range	22 mA	Full scale value flashing	ON	ON	OFF	ON	active	active	passive	active
System failure	0 mA	Error code	OFF	OFF	ON	ON	passive	passive	passive	passive
Maintenance request	4-20 mA <sup>6)</sup>	Measured value	OFF	OFF	flashing <sup>5)</sup>	ON	passive	passive	active	active
Self-test	2 / 4 mA <sup>1)</sup>	Self - test	OFF	OFF	flashing	ON	passive	passive	passive	active
Self-test Monitoring	4-20 mA <sup>7)</sup>	Self - test	OFF	OFF	flashing	ON	passive	passive	passive	passive
Service-Mode (password protected)	2 / 4 mA <sup>1)</sup>	Service menu	OFF	OFF	flashing	ON	passive	passive	passive	active
Info - Mode (no password)	4-20 mA	Service menu	OFF	OFF	OFF	ON	passive	passive	passive	active
Power off	0 mA	-	OFF	OFF	OFF	OFF	passive	passive	passive	passive

- 1) Program in menu **Service Output**.
- 2) If an alarm has been set to AUTO RESET, the actual status is displayed. If it has been set to HOLD, the last alarm status will stay. To delete a latching alarm press the **Reset- Button**.
- 3) Ex works setting, can be changed by user.
- 4) Alarm output active means the open collector output is current fed. The SF output is always active in order to detect a potential power outage.
- 5) Periodic double flash every 5 seconds.
- 6) Ex works setting, can be changed by user.
- 7) No ex works setting, can be set by user. The SF Relay is passive in this mode, to differentiate from the 4-20 mA in the measuring mode.
- 8) The measured value alternates with the message „**Zero adjustment failed**“ or „**Calibration failed**“ in case any of these procedures has failed.

## 7 Technical Data

Product name:	Stattox 560
Type:	5377
Manufacturer:	COMPUR Monitors GmbH & Co. KG, Weissenseestr. 101, D-81539 Munich
Power supply:	24 (16-30) VDC
Power consumption:	max. 2.7 W (8.7 W for COCl <sub>2</sub> ) at input voltage ≤ 26 VDC
Operating temperature:	-30°C to +60°C
Storage temperature:	-30°C to +60°C
Pressure:	700 to 1300 hPa
Humidity:	0% to 99% r. H. (non condensing)
Application:	II 2G
Explosion protection:	Ex d ib IIC T4 Gb (at U <sub>m</sub> = 30 VDC for all connections)
EC type examination certificate:	BVS 16 ATEX E 065 X (X: the measuring function according Annex II, point 1.5.5 of directive 2014/34/EU is not part of the EC type examination certificate.)
Protection class EN60529:	IP 66 (gas intake IP54)
Display:	2 x 16 signs, illuminated
Housing:	Cast aluminum epoxide varnished / stainless steel
Connections:	10-core cable tail (1 m) or 7-pin eXLink plug
Open-Drain-outputs:	2 x alarm, 1 x system failure, 1 x maintenance request Characteristic values max. 30 VDC / 2.5 A
SF-Open-Drain- output:	In normal operation active (conductive)
Analog output:	0 mA in case of system failure 2 or 4 mA in the service mode, programmable 4 - 20 mA in the measuring mode 22 mA when full scale is exceeded max. burden: 450 Ohm
EMC:	EN 61000-6-4:2007 + A1:2011 / EN 50270:2015 (type 2)
Functional safety:	SIL 2 compliant according to IEC 61508:2010
Automatic self-test:	every 24 hours, time is selectable
Weight:	ca. 4800 g
Dimensions:	121 x 294 x 138 mm (W x H x D)

## 8 EU Declaration of Conformity

---

**EU- KONFORMITÄTSERKLÄRUNG  
EU-DECLARATION OF CONFORMITY  
UE-DÉCLARATION DE CONFORMITÉ**

---

**COMPUR**  
Monitors

**Compur Monitors GmbH & Co.KG  
Weißenseestraße 101  
D 81539 München**

erklärt in alleiniger Verantwortung, dass das Produkt  
hereby declares in sole responsibility, that the product  
déclare comme seul responsable, que le produit

**Stattox 560 Messkopf Typ 5377  
Stattox 560 Sensor Head type 5377  
Stattox 560 Tête de détection type 5377**

den folgenden EU-Richtlinien und den entsprechenden harmonisierten Normen entspricht.  
complies with the following EU directives and corresponding harmonized standards.  
correspond aux directives européennes suivantes et à leurs normes harmonisées.

**Richtlinie/Directive 2014/34/EU  
EN 60079-0:2018  
EN 60079-1:2014  
EN 60079-11:2012**

**BVS 16 ATEX E 065 X**  
Notified body: 0408  
TÜV Austria Deutschland,  
Kurze Straße 40, D-70794 Filderstadt

**Richtlinie/Directive 2014/30/EU  
EN 61000-6-4:2007 +A1:2011  
EN 50270:2015 (Typ 2 / type 2)**

**Richtlinie/Directive 2011/65/EU (RoHS)**

München, 21. 03. 2024  
Munich, 2024-03-21

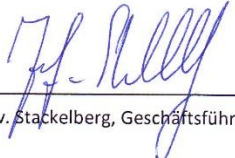
  
\_\_\_\_\_  
Dr. Josef v. Stackelberg, Geschäftsführer

---

COMPUR Monitors GmbH & Co.KG  
Postfach 900147  
D-81501 München  
DIN EN ISO 9001:2015 zertifiziert

Tel. Nr. ++49 89 62038268  
Internet <http://www.compur.com>  
E-Mail: [compur@compur.de](mailto:compur@compur.de)

Geschäftsführer:  
Dr. Josef v. Stackelberg

Specifications are subject to change without notice, and are provided only for comparison of products. The conditions under which our products are used, are beyond our control. Therefore, the user must fully test our products and / or information to determine suitability for any intended use, application, condition or situation. All information is given without warranty or guarantee. Compur Monitors disclaims any liability, negligence or otherwise, incurred in connection with the use of the products and information. Any statement or recommendation not contained herein is unauthorized and shall not bind Compur Monitors. Nothing herein shall be construed as a recommendation to use any product in conflict with patents covering any material or device or its use. No license is implied or in fact granted under the claims of any patent. Instruments are manufactured by Compur Monitors GmbH & Co. KG, Munich. The General Conditions of Supply and Service of Compur Monitors GmbH & Co. KG, Munich, are applicable.

Compur Monitors GmbH & Co. KG  
Weißenseestraße 101  
D-81539 München  
Phone 0049 (0) 89 62038 268  
Fax 0049 (0) 89 62038 184  
Internet: [www.compur.com](http://www.compur.com)  
E-Mail: [compur@compur.de](mailto:compur@compur.de)